

**Modular Wall**  
systems™

# Lighting Installation Guide

12 Volt

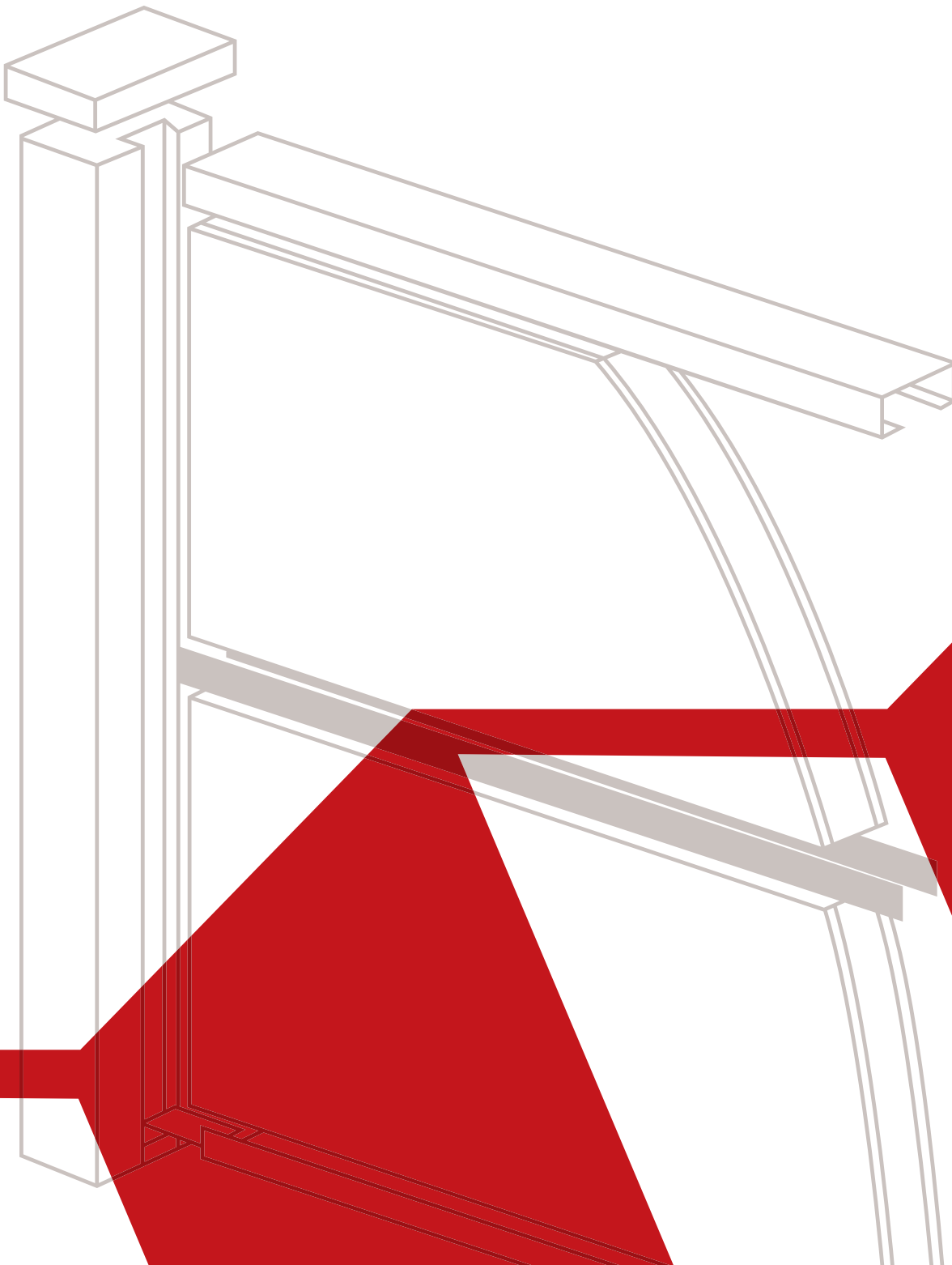

# Introduction

This guide will show you how to install 12 volt lighting into your Modular Wall posts.



## IMPORTANT

This Guide is not intended to give any 240 volt Electrical advice. Electricity can be dangerous and 240 volt connections should only be undertaken by a licenced electrician.

With this in mind we recommend lighting that is 12 volt (or less) unless installed and certified by a licenced electrician.

The lighting examples pictured below are all 12 volt LED systems. You may find that most electrical retailers don't stock a large range of suitable 12 volt or LED lighting but generally these can be sourced more readily through electrical wholesalers such as John R Turk or Rexel and many more.

Before heading off to purchase your lights it is important to know the number of lights that will be installed as well as the total length of cable required. Allow ample cable length for looping down to each light position in each post & enough 'slack' to allow the cable to be pulled through the face of the post for easy connecting to the light fitting. Doing this will ensure the correct type and quantity of materials can be bought.



The cabling is generally best run in two stages.

Stage 1 - Once your Posts have been installed prepare the posts as outlined below prior to any panels being installed. Outlined in steps 1&2 below.

Stage 2 - Run your cabling once your Panels have been installed. Outlined in steps 3&4 below.

## Tools Needed:



Tape Measure

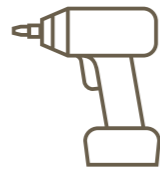

Drill/Driver

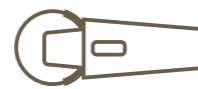

Angle Grinder



Wire Snips

# Installation

## STEP 1 - Work out the entry point for your cable

Once your Posts have been installed drill a hole in the Post at the point the cable will enter (this would normally be below ground level) or if the cable is to enter the Post at the start of a wall then you can run the cable behind the 'End Post Infill'.

Any hole should be treated accordingly & sealed up with an exterior grade silicone after the cable installation is complete.

Note - Consideration should also be given to a suitable location for the 12 volt transformer. This would normally be close to the power source.

## STEP 2 - Prepare your posts

Cut the necessary exit and entry slots for the cable in your Posts at this point.

The normal method would be to loop the cable inside the posts and run it along the top of the panel (under the wall capping) to the next post pushing the cable inside the unused joining strip rebate. If more room is required for larger cables you may remove a small amount of the polystyrene from the top of the panel to achieve this.

NOTE - Slotting of the post is best done for ease before the top panel has been inserted.

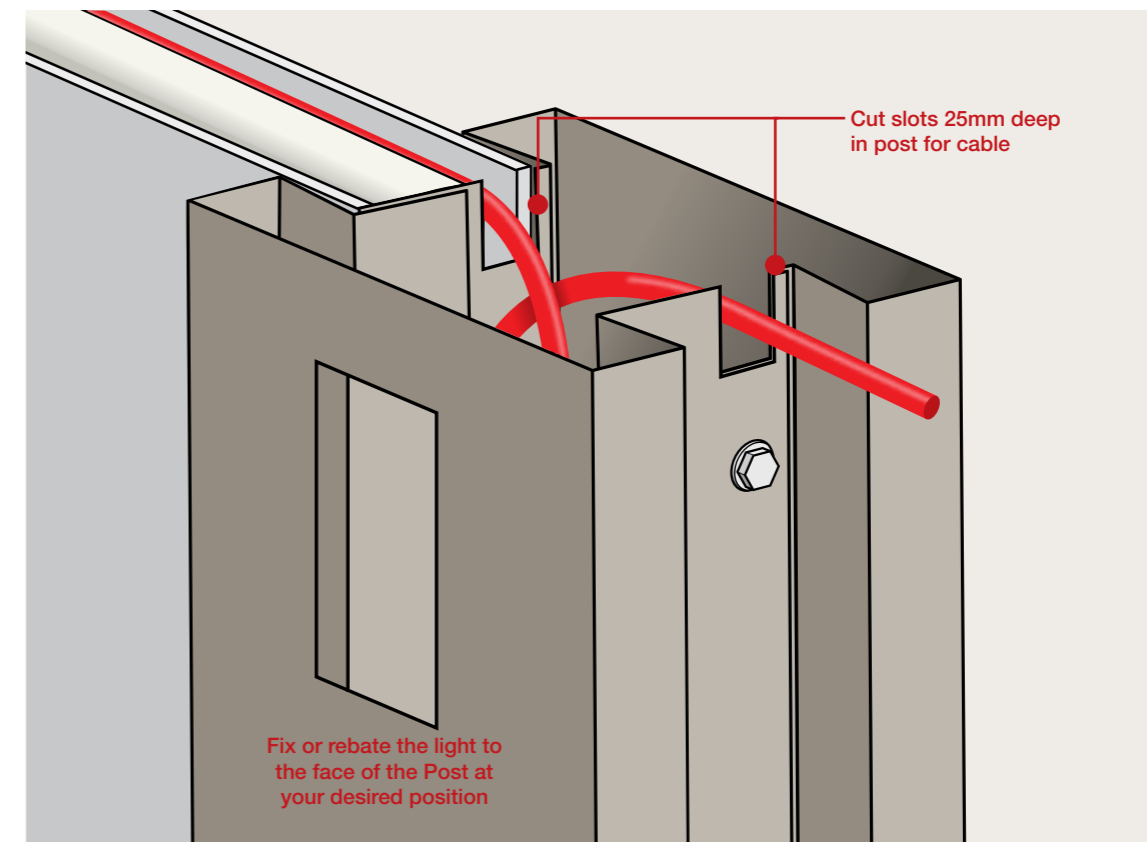

# Finished examples



## STEP 3 - Running the cable

As pictured run the cable up the post and loop inside consecutive posts. Give yourself a decent size loop to make connecting to the light fitting easier. You should be able to pull the cable to the outside of the post to work on the connection.

Continue this process in accordance with the number of lights you are installing.

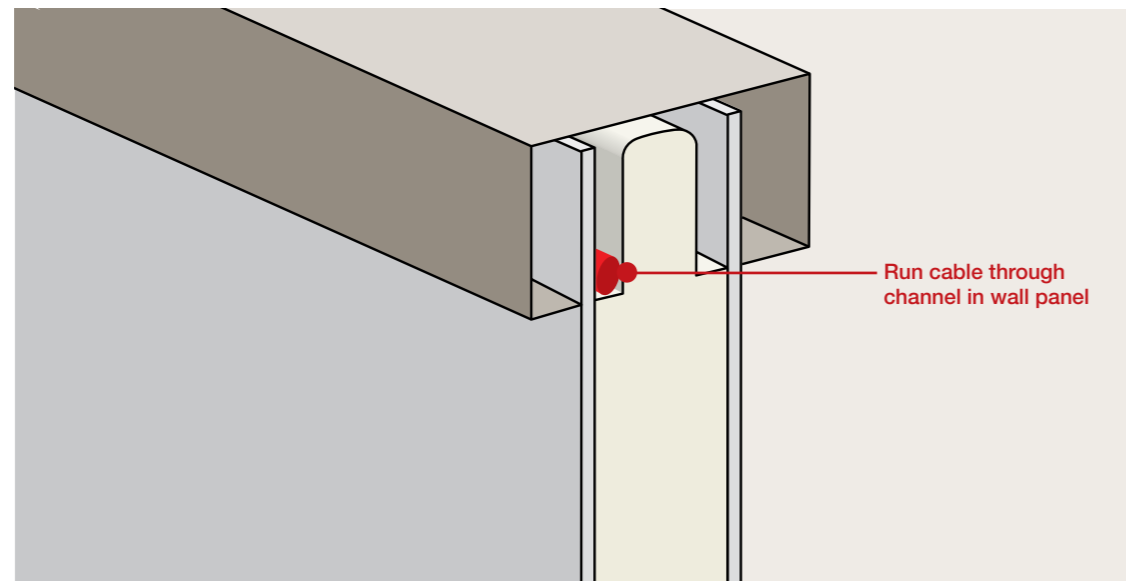

## STEP 4 - Connecting & mounting your lights

Follow the lighting manufacturer's recommendations for the electrical connection and fixing of the lights.

When mounting the lighting to the Post be sure to provide a waterproof seal/sealant where applicable so water ingress to the back of the light is not possible once installed.

